

Humble ISD 2014-2015

Student Use of Personal Technology Devices at School

Use of all personal electronic devices used on school property is subject to all guidelines of Responsible Use Policy and the Student Code of Conduct. The device may belong to the user but the network belongs to Humble ISD. Therefore, all Humble ISD network rules apply. If approved personal devices disrupt network operations, Humble ISD has the right to discontinue future use and the user may be liable for restitution for damages and/or disciplinary action.

- High School – Students are allowed to use personal technology devices that can access the Internet for educational purposes as determined by the classroom teacher. Students will be allowed to use the device between classes and in the cafeteria setting in a digitally responsible manner.
- Middle School – Students are allowed to use personal technology devices that can access the Internet for educational purposes as determined by the campus and/or classroom teacher. Students will not be allowed to use the devices during passing periods or in the cafeteria, or in any classroom without the express permission of the teacher.
- Elementary – Students in grades K-5 are not allowed to use personal technology devices at school.

Responsibility to keep the personal technology secure rests with the individual owner. Humble ISD is not liable for any device stolen or damaged on campus. The district cannot replace or provide financial restitution for any stolen or damaged personal technological device.

Users bringing personal devices on to school property agree to the following conditions:

- Personal electronic devices cannot be used to bypass the district internet filter. If network access is needed, connection to the filtered, wireless network provided by the District is required. Students using cellular service to bypass the district filter will be subject to disciplinary action.
- Students will not be required to bring a personal electronic device as a factor in grading or assessing student work. Students who do not have access to personal electronic devices will be provided with a device for in-class use, a partner to share with, or an alternative assignment.
- All personal devices must be in silent mode while on school campuses.
- Each user is responsible for his/her own device: set-up, maintenance, charging, and security. District personnel will not support, diagnose or repair personal devices.
- Personal technology must be charged prior to bringing it to school and must run off its own battery while at school.
- Technology may not be used to cheat on assignments or tests, or for non-instructional purposes (such as making personal phone calls and text/instant messaging, surfing the internet).
- Personal devices may not be used to take, send, or post photographs or videos of a person or persons on campus during school activities and/or hours for non-instructional purposes.
- Personal devices may only be used to access files, applications or internet sites which are relevant to the classroom curriculum. Non-instructional games are not permitted.
- Personal electronic devices are only to be used for educational purposes at the direction and under the supervision of a classroom teacher. The use of personal electronic devices during the school day is at the discretion of teachers and administrators.
- The teacher and campus administrators have the right to prohibit the use of personal electronic devices at certain times or during designated activities (i.e. testing, campus presentations, theatrical performances, guest speakers, etc.) that occur on campus.
- An administrator may examine a student's personal telecommunication device and search its contents, in accordance with disciplinary guidelines and the laws of the State of Texas.
- PRINTING from personal technology will not be possible at school.
- Use of personal devices to make phone calls in common areas and/or after school hours will be determined by the campus administration.
- Students are prohibited from trading or selling technology items to other students on district property, at school-sponsored events, or on school buses.
- If a student uses a personal device without authorization during the school day, the device will be confiscated. A confiscated device may be picked up from the principal's office for a fee of \$15 by the parent or student, as determined by the campus. Confiscated personal devices that are not retrieved will be disposed of after the notice required by law.

Accessing the District WiFi from your Personal Device

To use your personal device at school you will need to connect to the district wireless network. If your device has a 3G/4G connection, you are not allowed to use that at school. You must use the district wireless network and Internet filter.

On an iPhone or iPad:

1. Go to the Settings on your device.
2. Go to WiFi.
3. Select the network named Handhelds from the list of available networks.

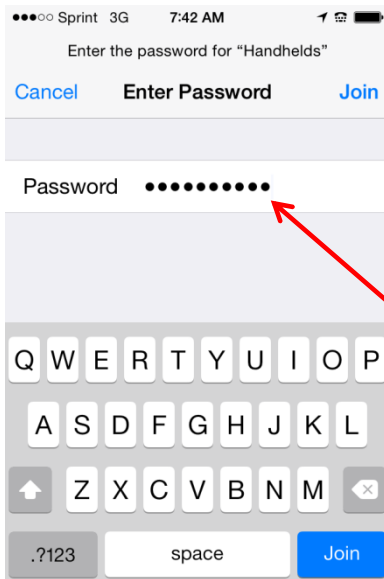

4. Enter the Password: in33dmyPHD
5. Choose Join.

On an Android device:

1. Go to the Settings on your device.
2. Go to WiFi.
3. Select the network named Handhelds from the list of available networks.

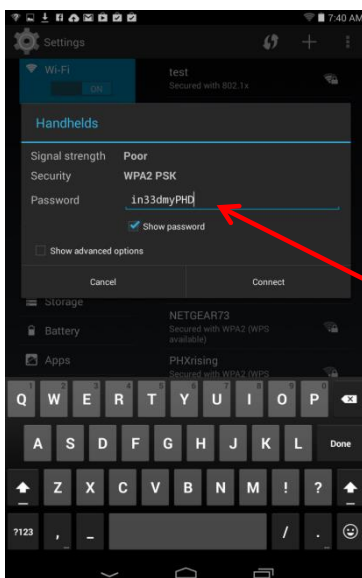
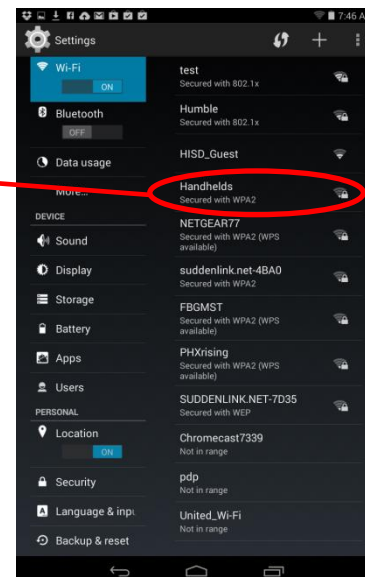

4. Enter the Password: in33dmyPHD
5. Choose Connect.